

Tous droits strictement réservés. Reproduction ou communication a des tiers interdite sous quelque forme que ce soit sans autorisation écrite du propriétaire. Propriété de c FCI. Droits de reproduction FCI.

All rights strictly reserved. Reproduction or issue to third parties in any form whatever is not permitted without written authority from the proprietor. Property of FCI. Copyright FCI.

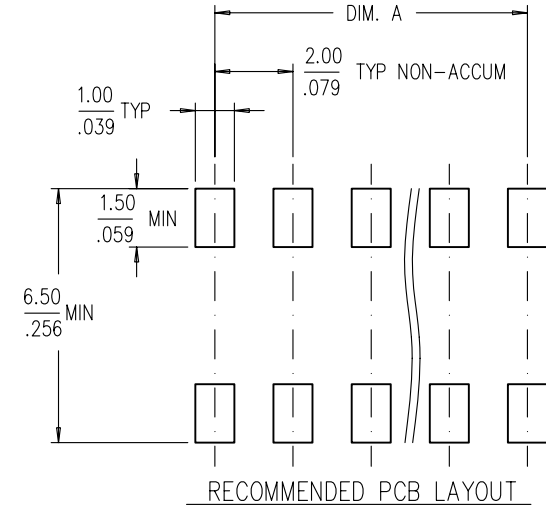
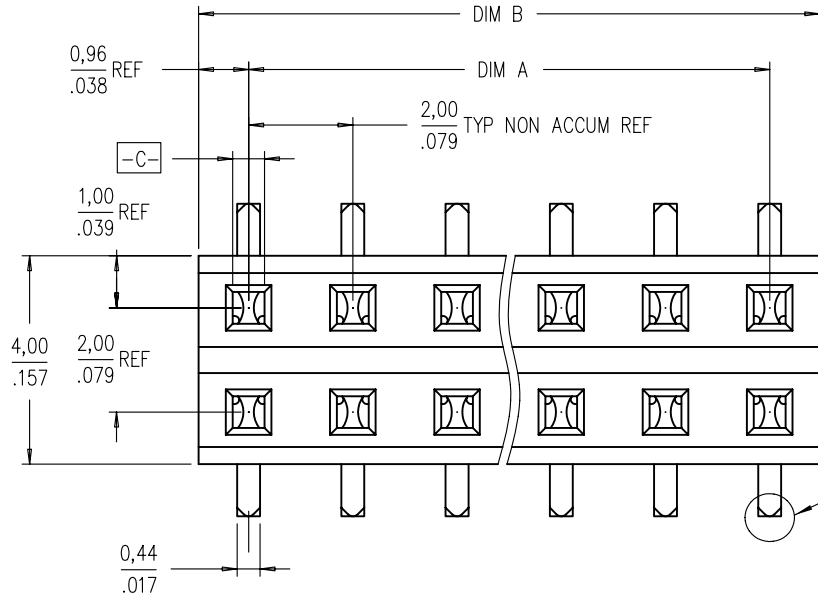

DETAIL A
NOTE 4

RECOMMENDED PCB LAYOUT

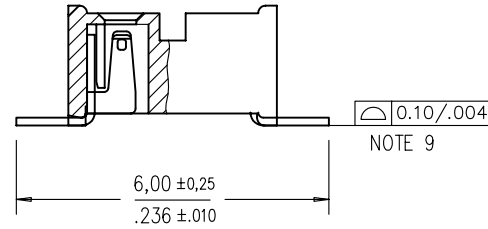
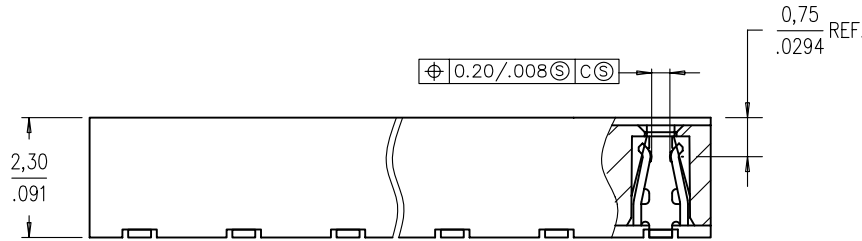

NOTE 9

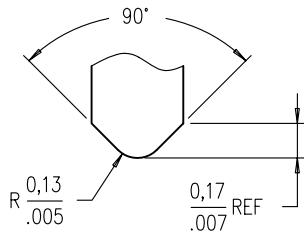

DETAIL A

CONFIDENTIAL

mat'l. code				tolerances unless otherwise specified		CUSTOMER COPY	 www.fciconnect.com
ltr	ecn no	dr	date	linear	X.X±.3/.XX±.01		
A	S10103	JPEH	7/31/01	linear	X.XX±.13/.XXX±.005	projection	title LOW PROFILE VCC 2.3 TOP ENTRY SMT ASSY
B	S10139	JPEH	10/3/01	linear	X.XXX±.051/.XXX±.0020		
C	S20092	JPEH	7/19/02	angles	ANGLES ±2°	 MM/INCH	product family LPVCC code -
D	S05-0007	KBM	1/19/05	dr	JPEH 7/19/02		
				engr	JPEH 7/19/02	scale	size dwg no A 55508
				chr	KB MAH 1/19/05		
				appd	JOEY NG 1/19/05	10:1	sheet 1 of 2
sheet index	revision sheet	D	D				
		1	2				

cage code
22526

PDM: Rev:D

STATUS: Released

Printed: Feb 01, 2007

ACAD

Tous droits strictement réservés. Reproduction ou communication a des tiers interdite sous quelque forme que ce soit sans autorisation écrite du propriétaire. Propriete de c FCI. Droits de reproduction FCI.

All rights strictly reserved. Reproduction or issue to third parties in any form whatever is not permitted without written authority from the proprietor. Property of FCI. Copyright FCI.

PRODUCT NO ⑤⑥	POSITIONS	DIM. A	DIM. B
55508-X04	2 X 2	2,00 / ,079	3,92 / ,154
-X06	2 X 3	4,00 / ,158	5,92 / ,233
-X08	2 X 4	6,00 / ,236	7,92 / ,312
-X10	2 X 5	8,00 / ,315	9,92 / ,391
-X12	2 X 6	10,00 / ,394	11,92 / ,469
-X14	2 X 7	12,00 / ,472	13,92 / ,548
-X16	2 X 8	14,00 / ,551	15,92 / ,627
-X18	2 X 9	16,00 / ,630	17,92 / ,706
-X20	2 X 10	18,00 / ,709	19,92 / ,784
-X22	2 X 11	20,00 / ,787	21,92 / ,863
-X24	2 X 12	22,00 / ,866	23,92 / ,942
-X26	2 X 13	24,00 / ,945	25,92 / 1,020
-X28	2 X 14	26,00 / 1,024	27,92 / 1,099
-X30	2 X 15	28,00 / 1,102	29,92 / 1,178
-X32	2 X 16	30,00 / 1,181	31,92 / 1,257
-X34	2 X 17	32,00 / 1,260	33,92 / 1,335
-X36	2 X 18	34,00 / 1,339	35,92 / 1,414
-X38	2 X 19	36,00 / 1,417	37,92 / 1,493
-X40	2 X 20	38,00 / 1,496	39,92 / 1,572
-X42	2 X 21	40,00 / 1,575	41,92 / 1,650
-X44	2 X 22	42,00 / 1,654	43,92 / 1,729
-X46	2 X 23	44,00 / 1,732	45,92 / 1,808
-X48	2 X 24	46,00 / 1,811	47,92 / 1,887
-X50	2 X 25	48,00 / 1,890	49,92 / 1,965

PLATING OPTIONS OVER CONTACT AREA

0 = 0,05um/2u" Au
1 = 0,76um/30u" Au
3 = 0,38um/15u" Au

NOTES :

- 1 HOUSING MAT'L : HIGH TEMP PLASTIC.
- 2 TERMINAL MAT'L : PHOSPHOR BRONZE.
- 3 TERMINAL RETENTION 0,5 Kg/1,1 Lbs.
- 4 'V' CUT OPTIONAL - MANUFACTURING PROCESS OPTION.
- ⑤ SOLDER TAILS OF P/N:55508-XXX IS TIN/LEAD PLATED.
- ⑥ SOLDER TAILS OF P/N: 55508-XXXLF IS 100% MATTE TIN PLATED.
- 7 PRODUCT DESCRIPTION CODE :

XXXXX-XXXLF

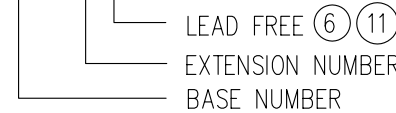

- 8 PACKAGING :
(a) XXXXX-XXX --- STD PACKAGING IN TUBE.
(b) XXXXX-XXXTR --- TAPE AND REEL PACKAGING WITH PICK-UP CAP (SEE FIG 1).
- 9 CO-PLANARITY :
FROM POSITION -X04 THRU -X38 : 0,10/.004
-X40 THRU -X50 : 0,12/.005
- 10 THE HOUSING WILL WITHSTAND EXPOSURE TO 255° C PEAK TEMPERATURE FOR 10 SECONDS IN A CONVECTION, INFRA-RED OR VAPOR PHASE REFLOW OVEN.
- ⑪ THIS PRODUCT MEETS EUROPEAN UNION DIRECTIVES AND OTHER COUNTRY REGULATIONS AS DESCRIBED IN GS-22-008.

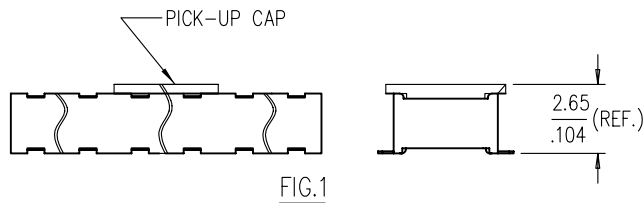

mat'l. code										tolerances unless otherwise specified		CUSTOMER COPY		CONFIDENTIAL	
ltr	ecn no	dr	date	linear	X.X±.3/.XX±.01	projection	FCI		www.fciconnect.com		title				
D					X.XX±.13/.XXX±.005	MM/INCH	A		LPVCC		LOW PROFILE VCC 2.3 TOP ENTRY SMT ASSY				
				angles	X.XXX±.051/.XXX±.0020	scale	A		55508		code				
				dr	JPEH 7/19/02	5:1	A		55508		-				
				engr	JPEH 7/19/02		A		55508		sheet				
				chr	KB MAH 1/19/05		A		55508		2 of 2				
				appd	JOEY NG 1/19/05		A		55508						
sheet index	revision sheet														

CONFIDENTIAL



www.fciconnect.com

LOW PROFILE VCC 2.3 TOP ENTRY SMT ASSY

product family LPVCC code -

size dwg no A 55508 sheet 2 of 2

cage code 22526

PDM: Rev:D

STATUS: Released

Printed: Feb 01, 2007

ACAD